

# GEAK 5: Gear Pump Horizontal or Vertical Bulkhead

## GEAK 5

### Gear Pump Horizontal or Vertical Bulkhead

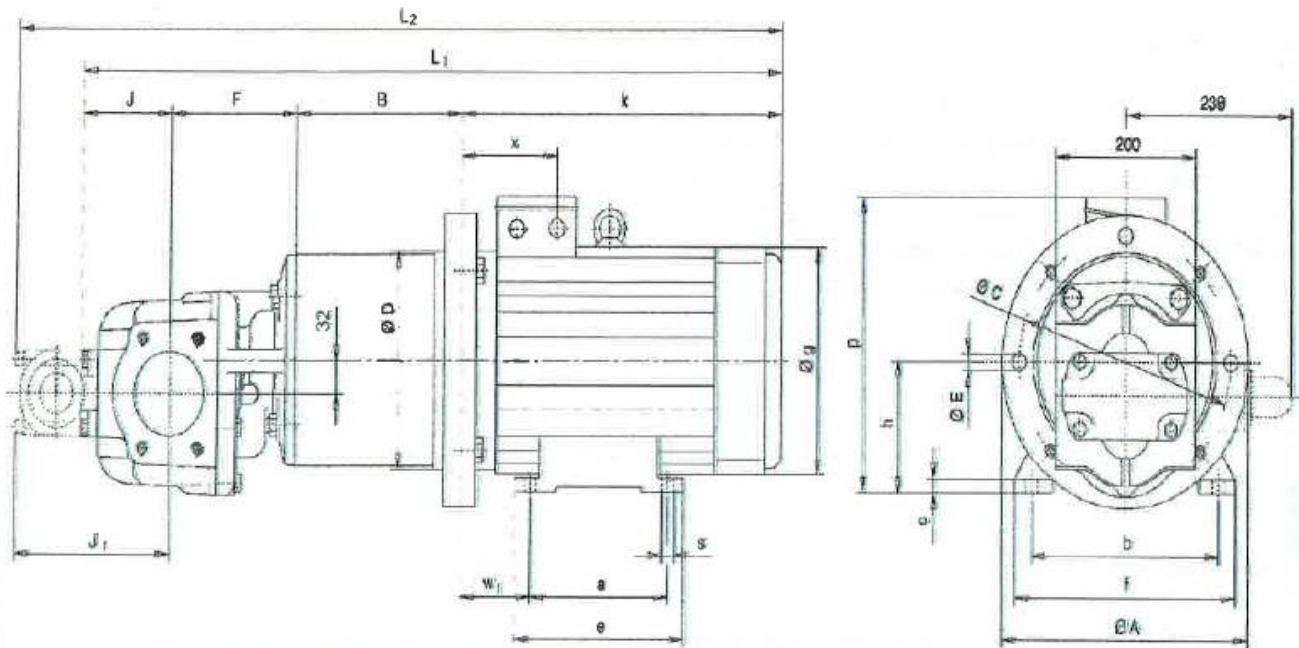

Motor Size	Ø A	B	Ø C	Ø D	Ø E	a	b	c	e	f	g	h	k	Ø D	s	w1	x
132 S	300	195	265	234	14	140	216	12	187	264	265	132	368	283	12	89	112
132 M						178											
160 M	350	204	300	260	17	210	254	18	306	306	323	180	466	341	15	108	114
160 L						254											
180 M	350	204	300	260	17	241	279	22	343	344	370	180	519	387	15	121	136
180 L						279											

Motor Size	L1			L2			F			J			J1		
	5200	5250	5315	5200	5250	5315	5200	5250	5315	5200	5250	5315	5200	5250	5315
132 S	811	842	842	867	898	898									
132 M	842	873	873	898	929	929									
160 M							155	170	170	93	109	109	149	165	165
160 L	918	949	949	974	1005	1005									
180 M															
180 L	971	1002	1002	1027	1058	1058									

5200 DN<sub>s</sub> + DN<sub>d</sub> = SAE 2 1/2  
 5250 + 5300 DN<sub>s</sub> + DN<sub>d</sub> = SAE 3

Ask SCARDANA about all pump replacements

# SCARDANA®

DIVISION OF SCARDANA CORPORATION

FAX: (1) - 450 - 671 - 3898

TEL: (1) - 450 - 465 - 2480

E-mail : [service@scardana.com](mailto:service@scardana.com)

Web : [www.scardana.com](http://www.scardana.com)